

# Office to let

## City Offices

Bucharest, Sector 4, 2 Oltenitei Road

### Building information

Building status	Existing
Year of reconstruction	2015
Parking ratio	1 / 20 sq m
Total building area	31 000 sq m

### Commercial terms

Office space*	after login *
Parking	after login *
Service charge*	after login *
Minimum lease term	after login *
Availability	after login *

\* Asking terms for m<sup>2</sup>/month

### Location

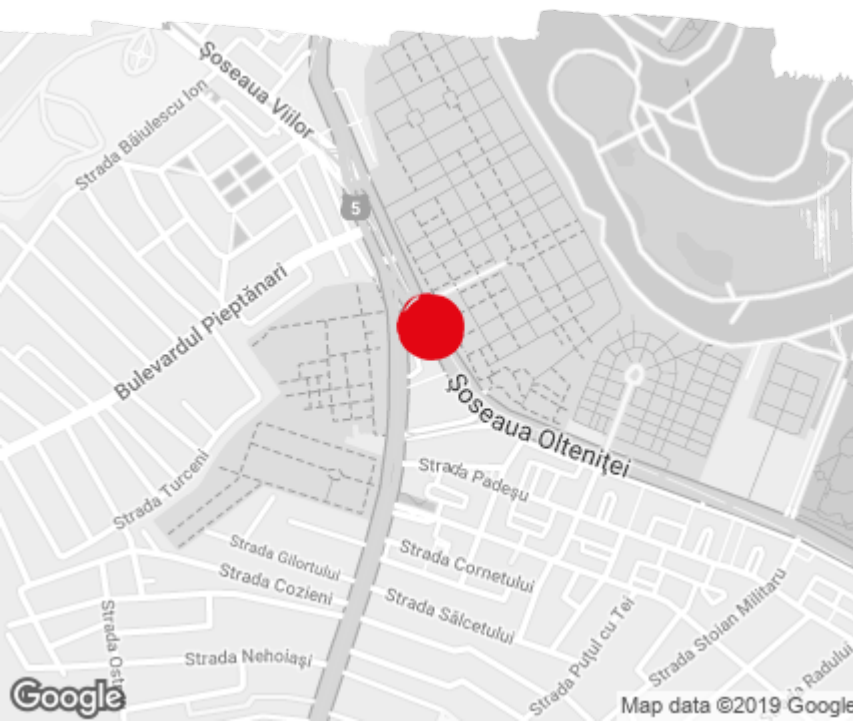

### Available space

1 250 sq m

Available office space

700 sq m

Minimum office space

Typical floor plan

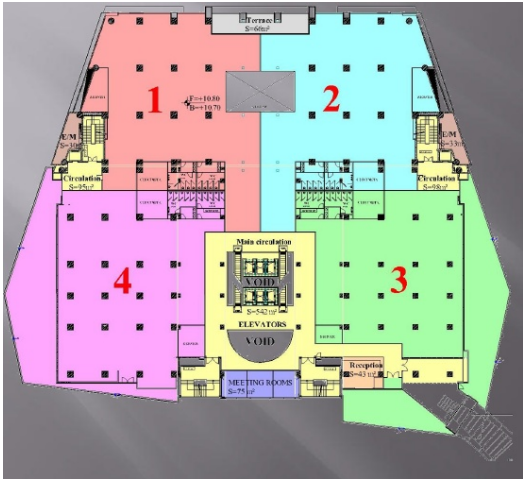

Available space

Floor	Vacant space	Availability
2	please contact us *	please contact us *
Total	after login *	

Public transport

Metro: M2  
Bus: 116, 232, 323, 611  
Tram: 1, 7, 11, 25

Contact

+40 21 302 3400  
More information